

HYATT LODGE

AT McDONALD'S CAMPUS

2815 JORIE BOULEVARD

OAK BROOK, IL 60523

T + (630) 568 1234

F + (630) 581 6619

thelodge.hyatt.com



you're more than welcome

2018.13

Hyatt Lodge Floorplan

BALLROOM LEVEL

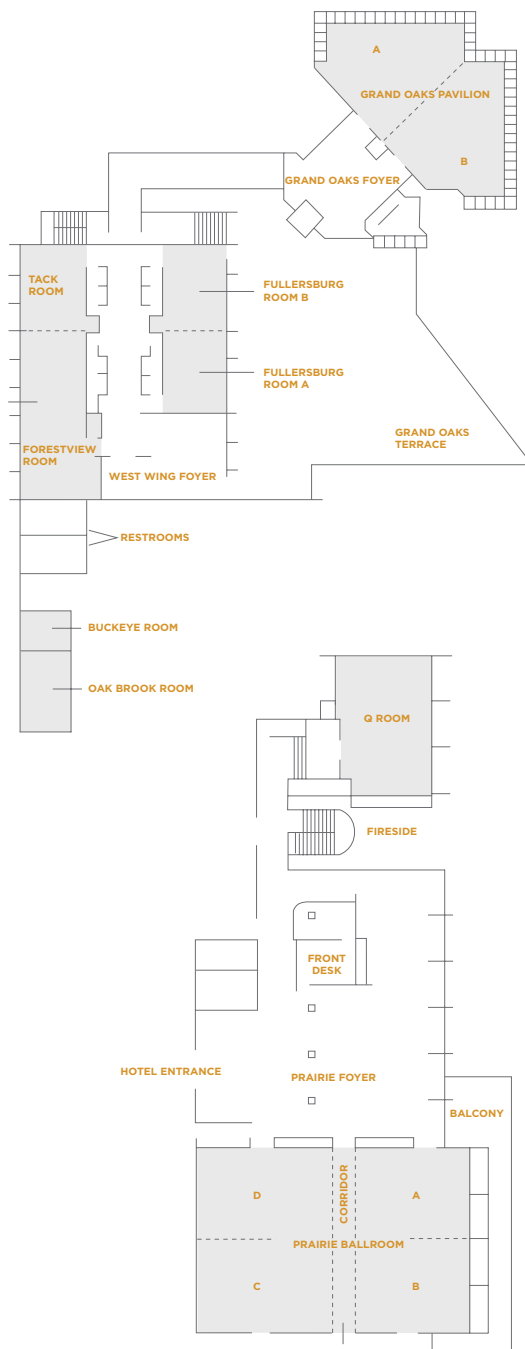

HYATT LODGE

AT McDONALD'S CAMPUS

2815 JORIE BOULEVARD

OAK BROOK, IL 60523

T + (630) 568 1234

F + (630) 581 6619

thelodge.hyatt.com



you're more than welcome

2018.13

Hamburger University Floorplans

FIRST LEVEL

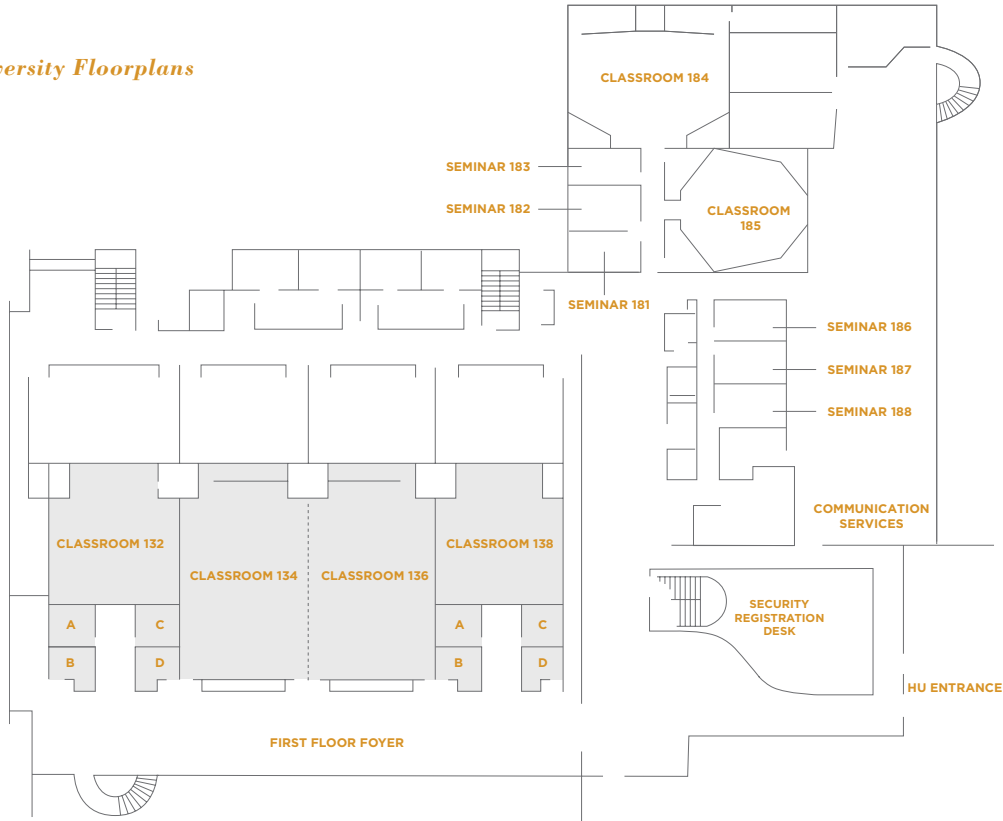

Hamburger University Floorplans

SECOND LEVEL

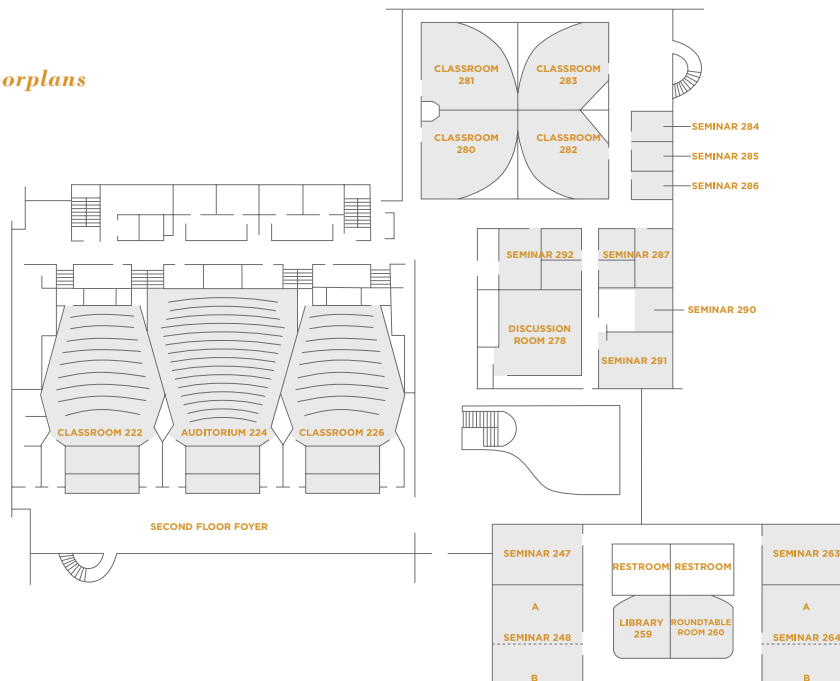

HYATT LODGE

AT McDONALD'S CAMPUS

2815 JORIE BOULEVARD
OAK BROOK, IL 60523

T + (630) 568 1234

F + (630) 581 6619

thelodge.hyatt.com



you're more than welcome

2018.13

Hyatt Lodge Room Capacities & Dimensions



Room Name	Room Dimensions L x W x H	Room Size Sq. Ft.	Banquet	Reception	Theater	Classroom	Boardroom	U-Shape	Hollow Square	Table Top Exhibits
BALLROOM LEVEL										
Praire Ballroom	58' x 88' x 14'6"	5,104	350	450	500	300	—	—	—	50
Prairie A + B + Corridor	58' x 47' x 14'6"	2,726	150	250	250	144	—	—	—	40
Prairie C + D + Corridor	58' x 47' x 14'6"	2,726	150	250	250	144	—	—	—	40
Prairie A + B or C + D	40' x 58' x 14'6"	2,320	150	225	200	115	—	56	68	20
Prairie A, B, C or D	40' x 29' x 14'6"	1,160	60	100	100	40	30	30	38	10
Prairie Foyer	64' x 30' x 12'	1,920	100	—	—	—	—	—	—	15
Q Room	38' x 28' x 12'	1,064	70	100	70	40	20	20	24	8
Forestview Room	51' x 24' x 8'	1,224	70	125	115	55	55	50	55	10
Fullersburg Room A+B	51' x 21' x 8'	1,113	70	125	115	55	55	50	55	10
Fullersburg Room A or B	51' x 21' x 8'	546	30	30	30	18	20	15	20	4
Tack Room	51' x 24' x 8'	504	30	30	30	18	20	15	20	4
Buckeye Room	51' x 24' x 8'	312	—	—	—	—	8	—	—	—
Oak Brook Room	51' x 24' x 8'	416	—	—	—	—	16	—	—	—
Grand Oaks Pavilion	96' x 108' x 12'	3,800	200	250	200	125	—	—	—	20
Grand Oaks Pavilion A	55' x 53' x 12'	1,900	100	125	75	—	—	—	—	10
Grand Oaks Pavilion B	41' x 55' x 12'	1,900	100	125	75	—	—	—	—	10
Grand Oaks Foyer	80' x 40' x 12'	3,200	40	—	—	—	—	—	—	5
West Wing Foyer	21' x 24' x 8'	504	30	—	—	—	—	—	—	3
Fireside	26' x 24' x 20'	—	30	30	—	—	—	—	—	—

HYATT LODGE

AT McDONALD'S CAMPUS

2815 JORIE BOULEVARD
OAK BROOK, IL 60523

T + (630) 568 1234

F + (630) 581 6619

thelodge.hyatt.com



you're more than welcome

2018.13

Hamburger University Room Capacities & Dimensions



Room Name	Room Dimensions L x W x H	Room Size Sq. Ft.	Banquet	Reception	Theater	Classroom	Boardroom	U-Shape	Hollow Square	Table Top Exhibit
HAMBURGER UNIVERSITY (FIRST LEVEL)										
SMART Classrooms* 132 / 138	36' x 42' x 9"	1,512	—	—	—	—	—	—	—	—
Classroom 132, A, B, C or D	14' x 11' x 9"	154	—	—	—	—	6	—	—	—
Classroom 138, A, B, C or D	14' x 11' x 9"	154	—	—	—	—	6	—	—	—
Classroom 134 / 136	36' x 56' x 9"	2,016	100	125	150	90	—	45	50	11
Classroom 134 + 136	72' x 56' x 9"	4,032	200	250	250	110	40	45	60	22
First Floor Foyer	—	—	100	—	—	—	—	—	—	12

HAMBURGER UNIVERSITY (SECOND LEVEL)

Tiered Classroom 222 or 226	48' x 56' x 15'10"	2,260	—	—	—	120	—	—	—	—
Tiered Auditorium 224	59' x 62' x 15'10"	2,880	—	—	299	—	—	—	—	—
Seminar 247/248 A or B	24' x 32' x 9'	768	40	—	—	25	20	20	25	—
Seminar 248/264 A + B	32' x 32' x 9'	1,536	80	80	100	50	30	36	30	10
Roundtable Room 260	22' x 32' x 9'	572	—	—	—	—	15	—	—	—
Seminar 263/264 A or B	24' x 32' x 9'	768	40	—	—	25	20	20	25	—
Discussion Room 278	32' x 34' x 15'	1,088	60	—	75	40	—	30	—	10
SMART Classroom 280 / 281 / 282 / 283	36' x 36' x 9'	1,296	—	—	—	—	—	—	—	—
Seminar 284/285/286	14.5' x 14.5' x 9'	166.75	—	—	—	—	6	—	—	—
Library 259	22' x 26' x 9'	572	—	—	25	15	10	15	—	—
Second Floor Foyer	—	—	100	—	—	—	—	—	—	14